

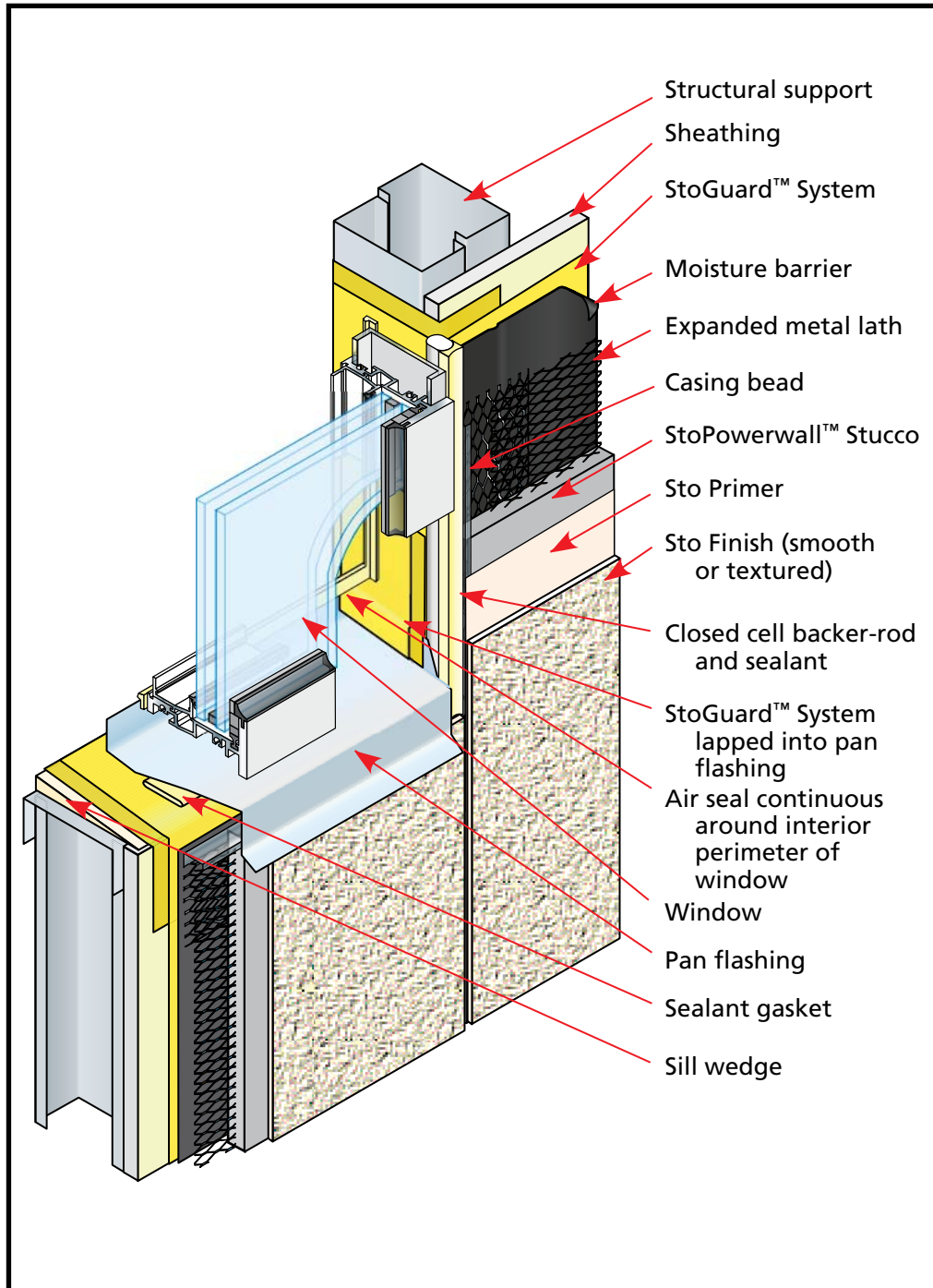

StoPowerwall™ Stucco with StoGuard™ System Commercial Window Sill

Detail No.: 4.22A

Date: October 2007



- Structural support
- Sheathing
- StoGuard™ System
- Moisture barrier
- Expanded metal lath
- Casing bead
- StoPowerwall™ Stucco
- Sto Primer
- Sto Finish (smooth or textured)
- Closed cell backer-rod and sealant
- StoGuard™ System lapped into pan flashing
- Air seal continuous around interior perimeter of window
- Window
- Pan flashing
- Sealant gasket
- Sill wedge

Notes:

1. Provide a mock-up installation and test using materials and subtrades associated with the project.
2. Prepare opening prior to the installation of the window. Coordinate installation with other associated subtrades. (Refer to Sto Detail 4.24A.)
3. Provide moisture barrier and other associated trim and accessories as noted in Sto Detail 4.01.
4. Provide pan flashing at sill to drain water to the exterior (See Sto Detail 4.26A).
5. In cold climates this detail will provide little insulation around the window opening. The designer should take care that condensation from vapor diffusion is prevented at the vapor impermeable barrier membrane around the opening.

ATTENTION

Sto products are intended for use by qualified professional contractors, not consumers, as a component of a larger construction assembly as specified by a qualified design professional, general contractor or builder. They should be installed in accordance with those specifications and Sto's instructions. Sto Corp. disclaims all, and assumes no, liability for on-site inspections, for its products applied improperly, or by unqualified persons or entities, or as part of an improperly designed or constructed building, for the nonperformance of adjacent building components or assemblies, or for other construction activities beyond Sto's control. Improper use of Sto products or use as part of an improperly designed or constructed larger assembly or building may result in serious damage to Sto products, and to the structure of the building or its components. **STO CORP. DISCLAIMS ALL WARRANTIES EXPRESS OR IMPLIED EXCEPT FOR EXPLICIT LIMITED WRITTEN WARRANTIES ISSUED TO AND ACCEPTED BY BUILDING OWNERS IN ACCORDANCE WITH STO'S WARRANTY PROGRAMS WHICH ARE SUBJECT TO CHANGE FROM TIME TO TIME.** For the fullest, most current information on proper application, clean-up, mixing and other specifications and warranties, cautions and disclaimers, please refer to the Sto Corp. website, www.stocorp.com.

www.stocorp.com